

A46 Newark Bypass

TR010065/APP/2.12

2.12 Special Category Land Plans

APFP Regulation 5(2)(i)

Planning Act 2008

Infrastructure Planning (Applications: Prescribed Forms and
Procedure) Regulations 2009

Volume 2

April 2024

Infrastructure Planning

Planning Act 2008

**The Infrastructure Planning
(Applications: Prescribed Forms and
Procedure) Regulations 2009**

A46 Newark Bypass

Development Consent Order 202[]

Special Category Land Plans

Regulation Number:	Regulation 5(2)(i)(iv)
Planning Inspectorate Scheme Reference	TR010065
Application Document Reference	TR010065/APP/2.12
Author:	A46 Newark Bypass Project Team, National Highways

Version	Date	Status of Version
Rev 1	April 2024	DCO Application

Table of Contents

1	Introduction	1
1.1	Purpose of this document	1
2	Scope and format of the Special Category Land Plans	2
3	Schedule of Plans included in this application document	3
4	Special Category Land Plans	4

1 Introduction

1.1 Purpose of this document

- 1.1.1 National Highways (the Applicant) has submitted an application under section 37 of the Planning Act 2008 for an order to grant development consent for the A46 Newark Bypass (the “Scheme”).
- 1.1.2 This document is part of a suite of documents which accompanies the application to grant development consent. A full description of all the Application Documents is provided in the Introduction to the Application (**TR010065/APP/1.3**) which also accompanies the application.
- 1.1.3 This document is included in the application to comply with Regulation 5(2)(i)(iv) and Regulation 5(4) of the Infrastructure Planning (Applications: Prescribed Forms and Procedures) Regulations 2009 (the “2009 Regulations”), which require:
- 5(2)(i) “a land plan identifying’....*
- (iv) where the land includes special category land and replacement land, that special category and replacement land”*
- 1.1.4 These Plans are also being submitted under Regulation 5(4) of the 2009 Regulations which states;
- “Where a plan comprises three or more separate sheets a key plan must be provided showing the relationship between the different sheets.”*
- 1.1.5 This set of plans specifically identifies the special category land within the Order Limits. The land within the Order Limits includes land that is open space, this being a type of land that fall within the definition of special category land. These plans identify those types of land, as well as whether it is proposed to permanently acquire land or rights or take temporary possession of such land.
- 1.1.6 In this plan set “the Order limits” means the “limits of land to be acquired or used permanently or temporarily within which the authorised development may be carried out.

2 Scope and format of the Special Category Land Plans

- 2.1.1 To ensure sufficient detail and clarity of information, the Special Category Land Plans, sheets 1 to 7, have been prepared at a scale of 1:2,500. The key plan uses a smaller scale than that prescribed in Regulation 5(3) of the 2009 Regulations but only so that the Project can be represented in a single sheet plan.
- 2.1.2 The Applicant has adopted the same consistent approach for the Special Category Land Plans as has been used for the:
 - a. the Land Plans (**TR010065/APP/2.2**),
 - b. the Crown Land Plans (**TR010065/APP/2.11**).
- 2.1.3 Each plot of land shown on the Special Category Land Plans has been clearly delineated and given a unique reference, which corresponds with the referencing or plot numbering used in the Book of Reference (**TR010065/APP/4.3**). The first number relates to the sheet on which the plot is located while the second number is used to distinguish between the plots.
- 2.1.4 In accordance with good practice, the plots have generally been numbered from west to east on each sheet following the sheet numbering system. The Order Limits are depicted on the Special Category Land Plans with a thicker red line to ensure that they are clearly distinguishable from the red lines used to depict plot boundaries.
- 2.1.5 Land shaded in pink indicates open space land to be permanently acquired.
- 2.1.6 Land shaded in blue indicates open space land to be used temporarily and rights to be permanently acquired.
- 2.1.7 Land shaded in green indicates open space land to be used temporarily.

3 Schedule of Plans included in this application document

Document Number	Drawing Title	Revision
HE551478-SKAG-LLO-CONWI_CONW-DR-VT-00027	SPECIAL CATEGORY LAND PLANS REGULATION 5(2)(i)(iv) KEY PLAN	C02
HE551478-SKAG-LLO-CONWI_CONW-DR-VT-00028	SPECIAL CATEGORY LAND PLANS REGULATION 5(2)(i)(iv) SHEET 1 OF 7	C02
HE551478-SKAG-LLO-CONWI_CONW-DR-VT-00029	SPECIAL CATEGORY LAND PLANS REGULATION 5(2)(i)(iv) SHEET 2 OF 7	C02
HE551478-SKAG-LLO-CONWI_CONW-DR-VT-00030	SPECIAL CATEGORY LAND PLANS REGULATION 5(2)(i)(iv) SHEET 3 OF 7	C02
HE551478-SKAG-LLO-CONWI_CONW-DR-VT-00031	SPECIAL CATEGORY LAND PLANS REGULATION 5(2)(i)(iv) SHEET 4 OF 7	C02
HE551478-SKAG-LLO-CONWI_CONW-DR-VT-00032	SPECIAL CATEGORY LAND PLANS REGULATION 5(2)(i)(iv) SHEET 5 OF 7	C02
HE551478-SKAG-LLO-CONWI_CONW-DR-VT-00033	SPECIAL CATEGORY LAND PLANS REGULATION 5(2)(i)(iv) SHEET 6 OF 7	C02
HE551478-SKAG-LLO-CONWI_CONW-DR-VT-00034	SPECIAL CATEGORY LAND PLANS REGULATION 5(2)(i)(iv) SHEET 7 OF 7	C02

4 Special Category Land Plans



NOTES

1. THIS PLAN SHOULD BE READ IN CONJUNCTION WITH THE LAND PLANS (TR010065/APP/2.2), CROWN LAND PLANS (TR010065/APP/2.11), BOOK OF REFERENCE (TR010065/APP/4.3), STATEMENT OF REASONS (TR010065/APP/4.1) AND THE DRAFT DCO (TR010065/APP/3.1).
2. ALL DIMENSIONS ARE IN METRES UNLESS OTHERWISE STATED.
3. DO NOT SCALE FROM THIS DRAWING, USE ONLY PRINTED DIMENSIONS.
4. ALL EASEMENTS, SERVITUDES AND PRIVATE RIGHTS ARE PROPOSED TO BE EXTINGUISHED ON LAND THAT IS TO BE ACQUIRED UNLESS STATED OTHERWISE IN THE BOOK OF REFERENCE.
5. THE NUMBER LABELS RELATE TO PLOT NUMBERS. PLEASE REFER TO THE BOOK OF REFERENCE FOR MORE INFORMATION ABOUT THESE PLOTS, INCLUDING THE APPROXIMATE AREA OF EACH PLOT. IN THIS NUMBERING CONVENTION, A PLOT NUMBER COMPRISES THE SHEET NUMBER FOLLOWED BY THE ACTUAL PLOT NUMBER, E.G: PLOT 1/1A, WHERE '1' IS THE SHEET NUMBER.

SERVICE LAYER CREDITS
 © CROWN COPYRIGHT AND DATABASE RIGHTS 2023 OS 100030649
 CONTAINS DATA FROM OS ZOOMSTACK
 © CROWN COPYRIGHT MATERIAL IS REPRODUCED WITH THE PERMISSION OF LAND REGISTRY UNDER DELEGATED AUTHORITY FROM THE CONTROLLER OF HMSO.

KEY TO SYMBOLS

(x/xx)	PLOT REFERENCE NUMBER (REFER TO BOOK OF REFERENCE)
[Pink Box]	LAND TO BE PERMANENTLY ACQUIRED
[Light Blue Box]	LAND TO BE USED TEMPORARILY AND RIGHTS TO BE PERMANENTLY ACQUIRED
[Light Green Box]	LAND TO BE USED TEMPORARILY
[Yellow Box]	LAND NOT SUBJECT TO COMPULSORY ACQUISITION
[Red Line]	ORDER LIMITS
[Black Line]	DESIGN LAYOUT

CO2	26/03/2024	DCO SUBMISSION	AS	AL	HF
REV.	DATE	AMENDMENT DETAILS	ORIG	CHK'D	APP'D

CLIENT
 national highways

PURPOSE OF ISSUE
 DCO APPLICATION

DEVELOPMENT CONSENT ORDER NUMBER
 TR010065

PROJECT TITLE
 A46 NEWARK BYPASS

DRAWING TITLE
 SPECIAL CATEGORY LAND PLANS
 REGULATION 5(2)(iv)
 KEY PLAN

ORIGINAL SIZE	A1	SCALE	1:13,000	PROJECT REF NO.	HE551478
DRAWING NUMBER	HE551478	ORIGINATOR	SKAG	VOLUME	LLO
LOCATION	CONWI_CONW	TYPE	DR	ROLE	VT
		NUMBER	00027	REVISION	C02

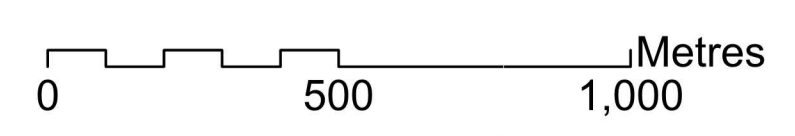

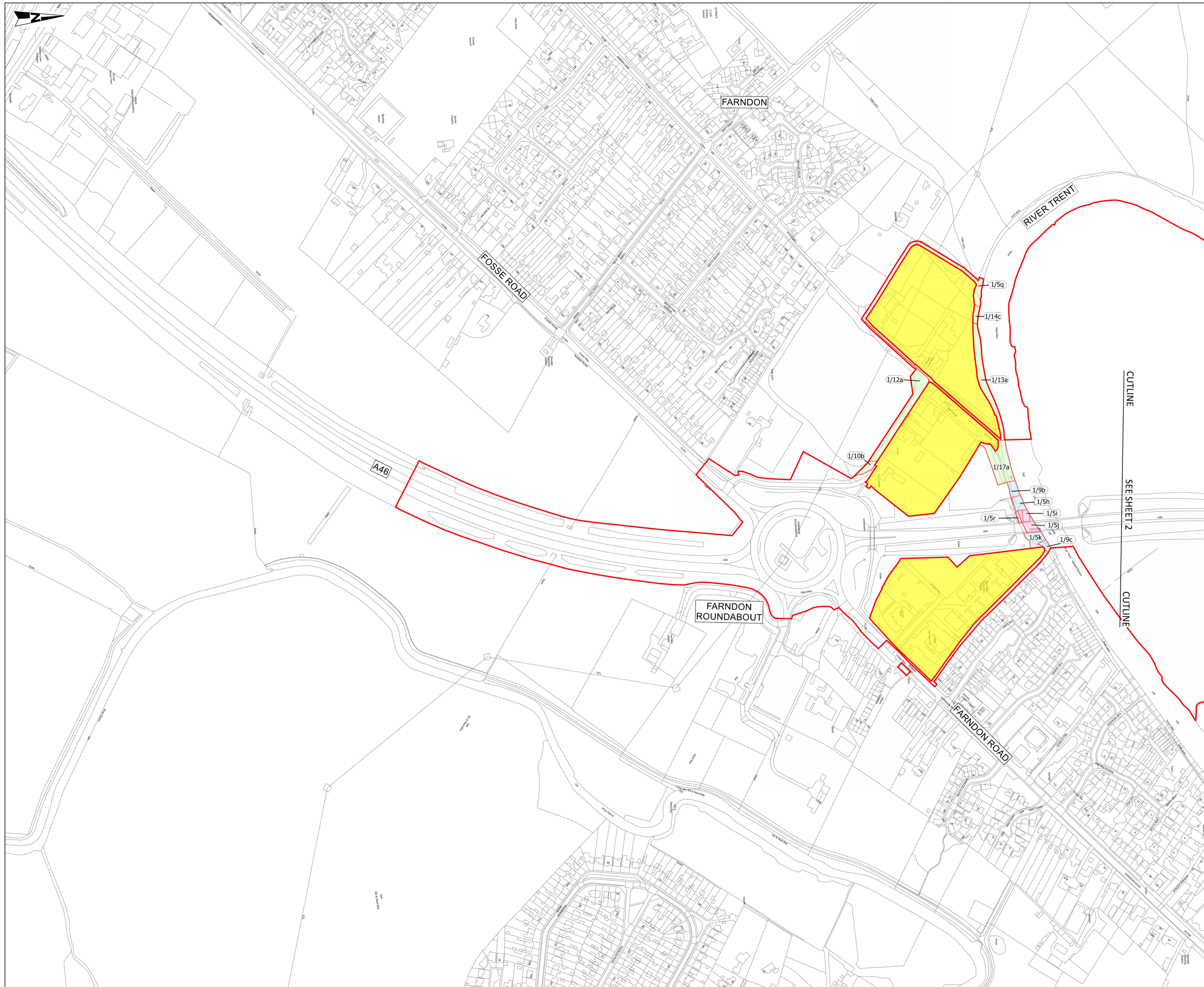

NOTES

1. THIS PLAN SHOULD BE READ IN CONJUNCTION WITH THE LAND PLANS (TR010065/APP/2.2), CROWN LAND PLANS (TR010065/APP/2.11), BOOK OF REFERENCE (TR010065/APP/4.3), STATEMENT OF REASONS (TR010065/APP/4.1) AND THE DRAFT DCO (TR010065/APP/3.1).
2. ALL DIMENSIONS ARE IN METRES UNLESS OTHERWISE STATED.
3. DO NOT SCALE FROM THIS DRAWING, USE ONLY PRINTED DIMENSIONS.
4. ALL EASEMENTS, SERVITUDES AND PRIVATE RIGHTS ARE PROPOSED TO BE EXTINGUISHED ON LAND THAT IS TO BE ACQUIRED UNLESS STATED OTHERWISE IN THE BOOK OF REFERENCE.
5. THE NUMBER LABELS RELATE TO PLOT NUMBERS. PLEASE REFER TO THE BOOK OF REFERENCE FOR MORE INFORMATION ABOUT THESE PLOTS, INCLUDING THE APPROXIMATE AREA OF EACH PLOT. IN THIS NUMBERING CONVENTION, A PLOT NUMBER COMPRISES THE SHEET NUMBER FOLLOWED BY THE ACTUAL PLOT NUMBER, E.G. PLOT 1/1A, WHERE '1' IS THE SHEET NUMBER.

SERVICE LAYER CREDITS
 © CROWN COPYRIGHT AND DATABASE RIGHTS 2023 OS 100030649
 CONTAINS DATA FROM OS ZOOMSTACK
 © CROWN COPYRIGHT MATERIAL IS REPRODUCED WITH THE PERMISSION OF LAND REGISTRY UNDER DELEGATED AUTHORITY FROM THE CONTROLLER OF HMSO.

KEY TO SYMBOLS

	PLOT REFERENCE NUMBER (REFER TO BOOK OF REFERENCE)
	LAND TO BE PERMANENTLY ACQUIRED
	LAND TO BE USED TEMPORARILY AND RIGHTS TO BE PERMANENTLY ACQUIRED
	LAND TO BE USED TEMPORARILY
	LAND NOT SUBJECT TO COMPULSORY ACQUISITION
	ORDER LIMITS

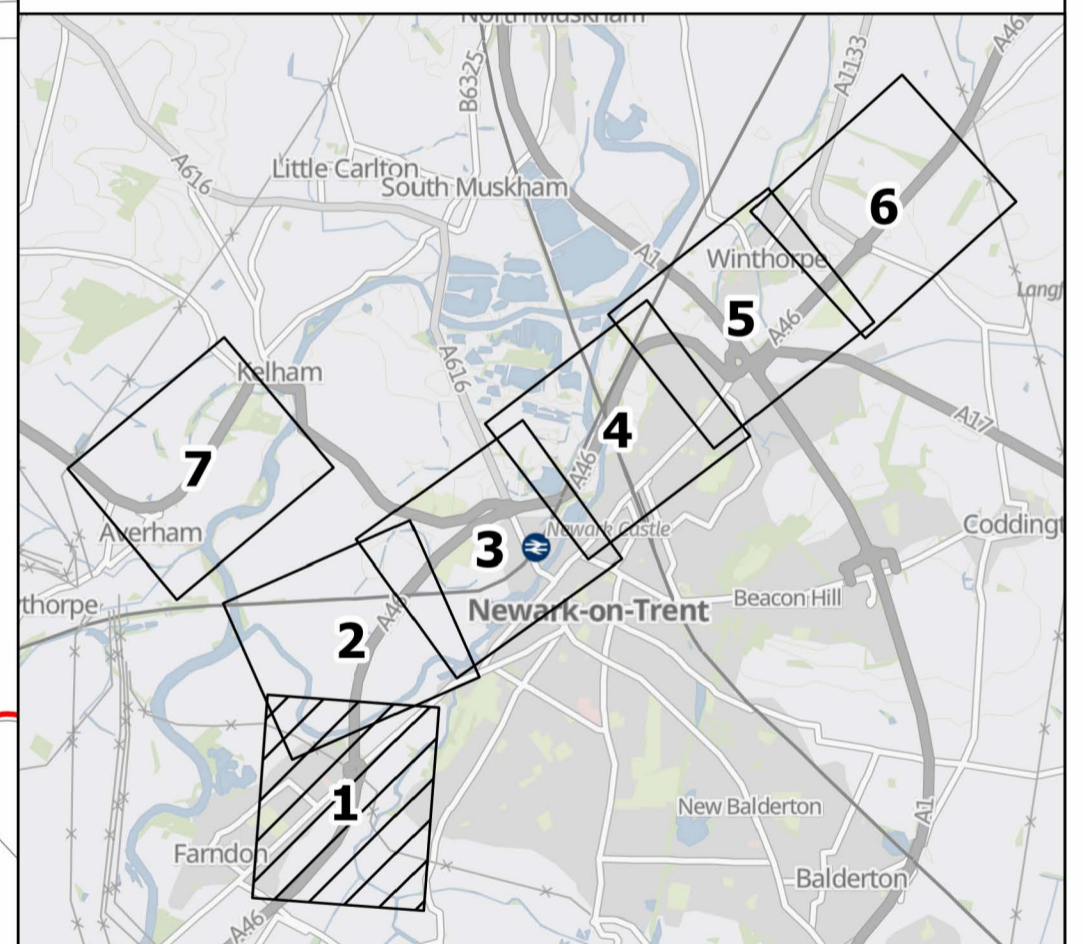

CO2	26/03/2024	DCO SUBMISSION	AS	AL	HF
REV.	DATE	AMENDMENT DETAILS	ORIG	CHK'D	APP'D

CLIENT

PURPOSE OF ISSUE
 DCO APPLICATION

DEVELOPMENT CONSENT ORDER NUMBER
 TR010065

PROJECT TITLE
 A46 NEWARK BYPASS

DRAWING TITLE
 SPECIAL CATEGORY LAND PLANS
 REGULATION 5(2)(i)(iv)
 SHEET 1 OF 7

ORIGINAL SIZE	A1	SCALE	1:2,500
DRAWING NUMBER	HE551478	ORIGINATOR	SKAG
HE FIN	CONWI_CONW	VOLUME	LL0
LOCATION	DR	TYPE	VT
		NUMBER	00028
PROJECT REF NO.	HE551478	REVISION	C02

© Skanska
 This document is issued for the party which commissioned it and for specific purposes connected with the captioned project only. It should not be relied upon by any other party or used for any other purpose.
 We accept no responsibility for the consequences of this document being relied upon by any other party, or being used for any other purpose, or containing any error or omission which is due to an error or omission in data supplied to us by other parties.

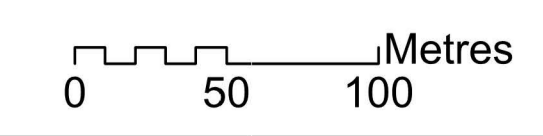

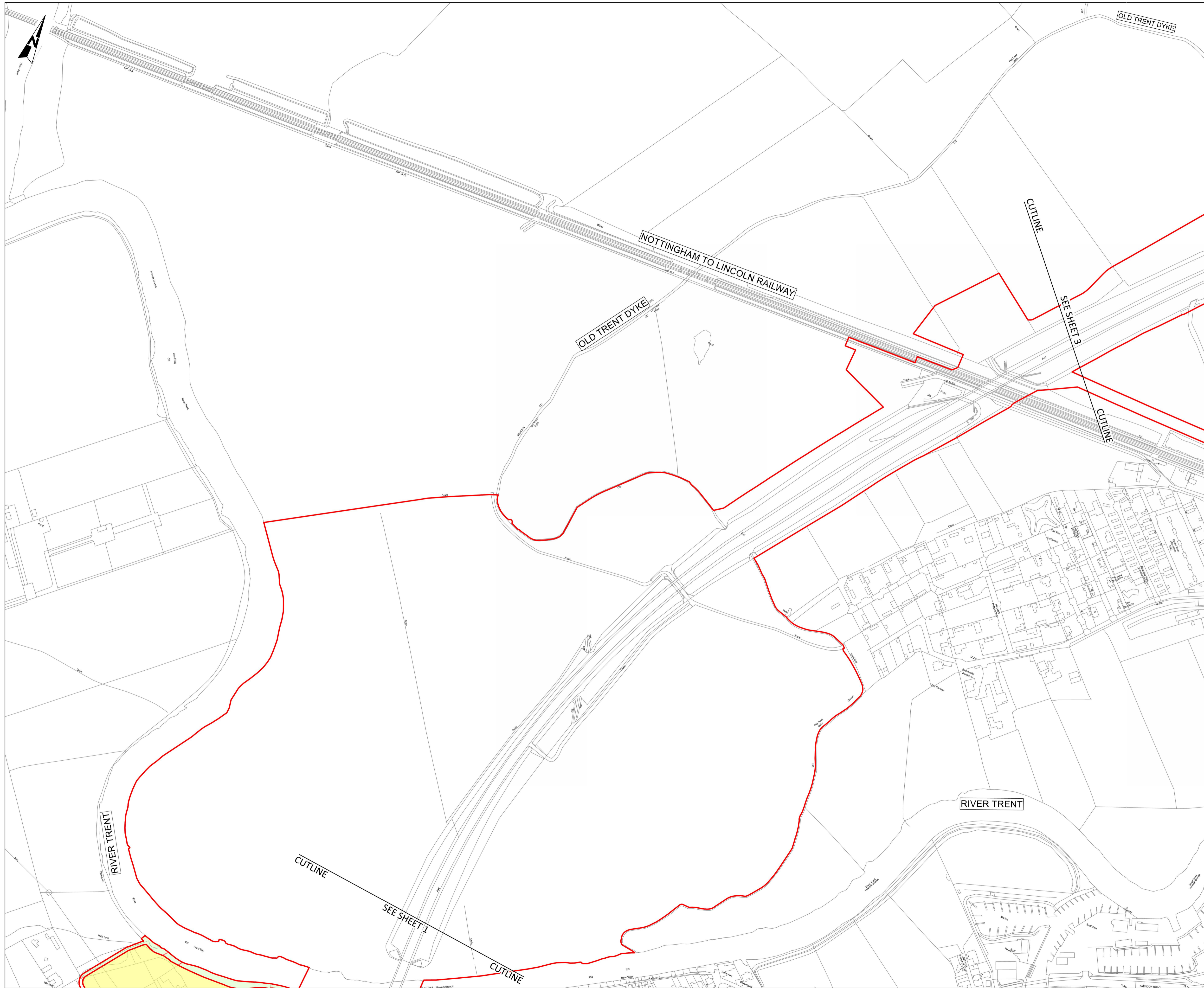

NOTES

1. THIS PLAN SHOULD BE READ IN CONJUNCTION WITH THE LAND PLANS (TR010065/APP/2.2), CROWN LAND PLANS (TR010065/APP/2.11), BOOK OF REFERENCE (TR010065/APP/4.3), STATEMENT OF REASONS (TR010065/APP/4.1) AND THE DRAFT DCO (TR010065/APP/3.1).
2. ALL DIMENSIONS ARE IN METRES UNLESS OTHERWISE STATED.
3. DO NOT SCALE FROM THIS DRAWING, USE ONLY PRINTED DIMENSIONS.
4. ALL EASEMENTS, SERVITUDES AND PRIVATE RIGHTS ARE PROPOSED TO BE EXTINGUISHED ON LAND THAT IS TO BE ACQUIRED UNLESS STATED OTHERWISE IN THE BOOK OF REFERENCE.
5. THE NUMBER LABELS RELATE TO PLOT NUMBERS. PLEASE REFER TO THE BOOK OF REFERENCE FOR MORE INFORMATION ABOUT THESE PLOTS, INCLUDING THE APPROXIMATE AREA OF EACH PLOT. IN THIS NUMBERING CONVENTION, A PLOT NUMBER COMPRISES THE SHEET NUMBER FOLLOWED BY THE ACTUAL PLOT NUMBER, E.G: PLOT 1/1A, WHERE '1' IS THE SHEET NUMBER.

SERVICE LAYER CREDITS
 © CROWN COPYRIGHT AND DATABASE RIGHTS 2023 OS 100030649
 CONTAINS DATA FROM OS ZOOMSTACK
 © CROWN COPYRIGHT MATERIAL IS REPRODUCED WITH THE PERMISSION OF LAND REGISTRY UNDER DELEGATED AUTHORITY FROM THE CONTROLLER OF HMSO.

KEY TO SYMBOLS

	PLOT REFERENCE NUMBER (REFER TO BOOK OF REFERENCE)
	LAND TO BE PERMANENTLY ACQUIRED
	LAND TO BE USED TEMPORARILY AND RIGHTS TO BE PERMANENTLY ACQUIRED
	LAND TO BE USED TEMPORARILY
	LAND NOT SUBJECT TO COMPULSORY ACQUISITION
	ORDER LIMITS

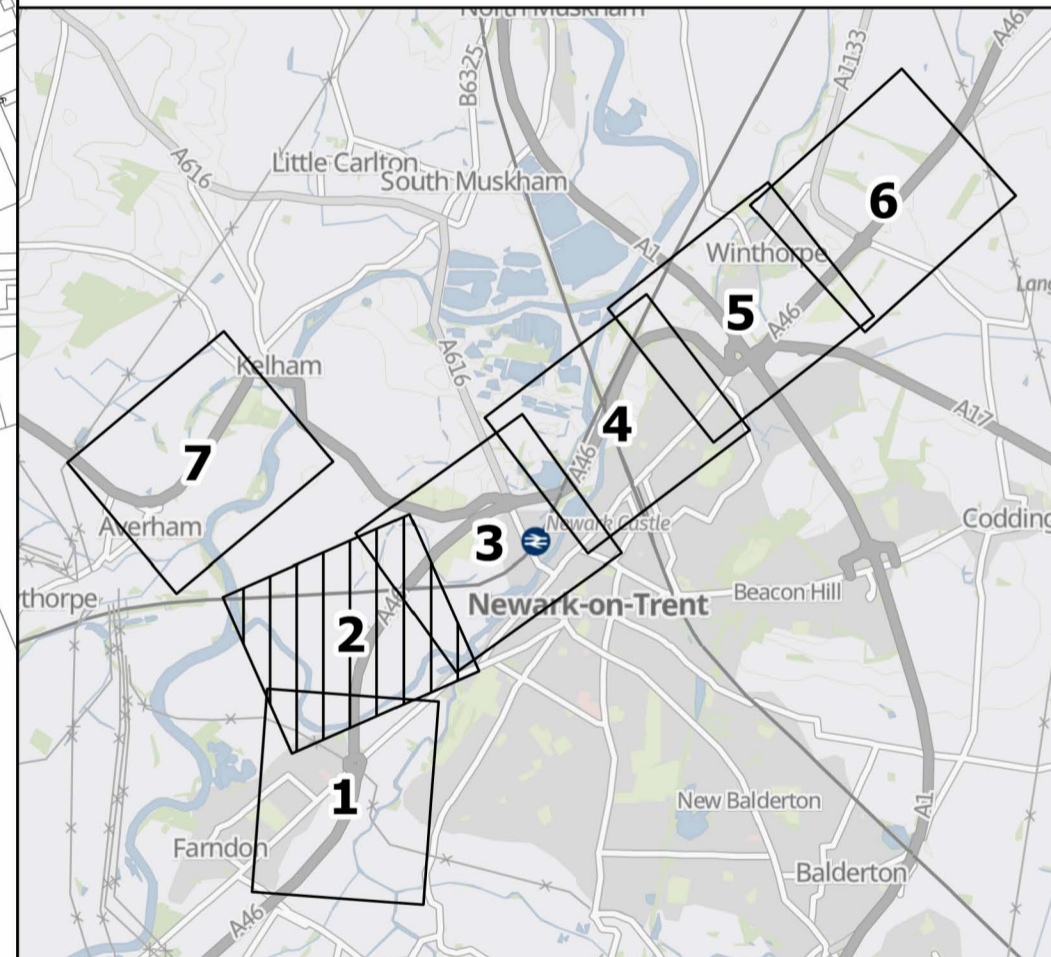

C02	26/03/2024	DCO SUBMISSION	AS	AL	HF
REV.	DATE	AMENDMENT DETAILS	ORIG	CHK'D	APP'D

CLIENT
 national highways

PURPOSE OF ISSUE
 DCO APPLICATION

DEVELOPMENT CONSENT ORDER NUMBER
 TR010065

PROJECT TITLE
 A46 NEWARK BYPASS

DRAWING TITLE
 SPECIAL CATEGORY LAND PLANS
 REGULATION 5(2)(i)(iv)
 SHEET 2 OF 7

ORIGINAL SIZE	A1	SCALE	1:2,500
---------------	----	-------	---------

DRAWING NUMBER HE PIN	ORIGINATOR SKAG	VOLUME LLO	PROJECT REF NO. HE551478
LOCATION CONWI_CONW	TYPE DR	ROLE VT	REVISION 00029
		NUMBER C02	

© Skanska
 This document is issued for the party which commissioned it and for specific purposes connected with the captioned project only. It should not be relied upon by any other party or used for any other purpose.
 We accept no responsibility for the consequences of this document being relied upon by any other party, or being used for any other purpose, or containing any error or omission which is due to an error or omission in data supplied to us by other parties.

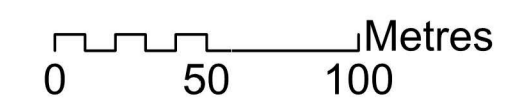

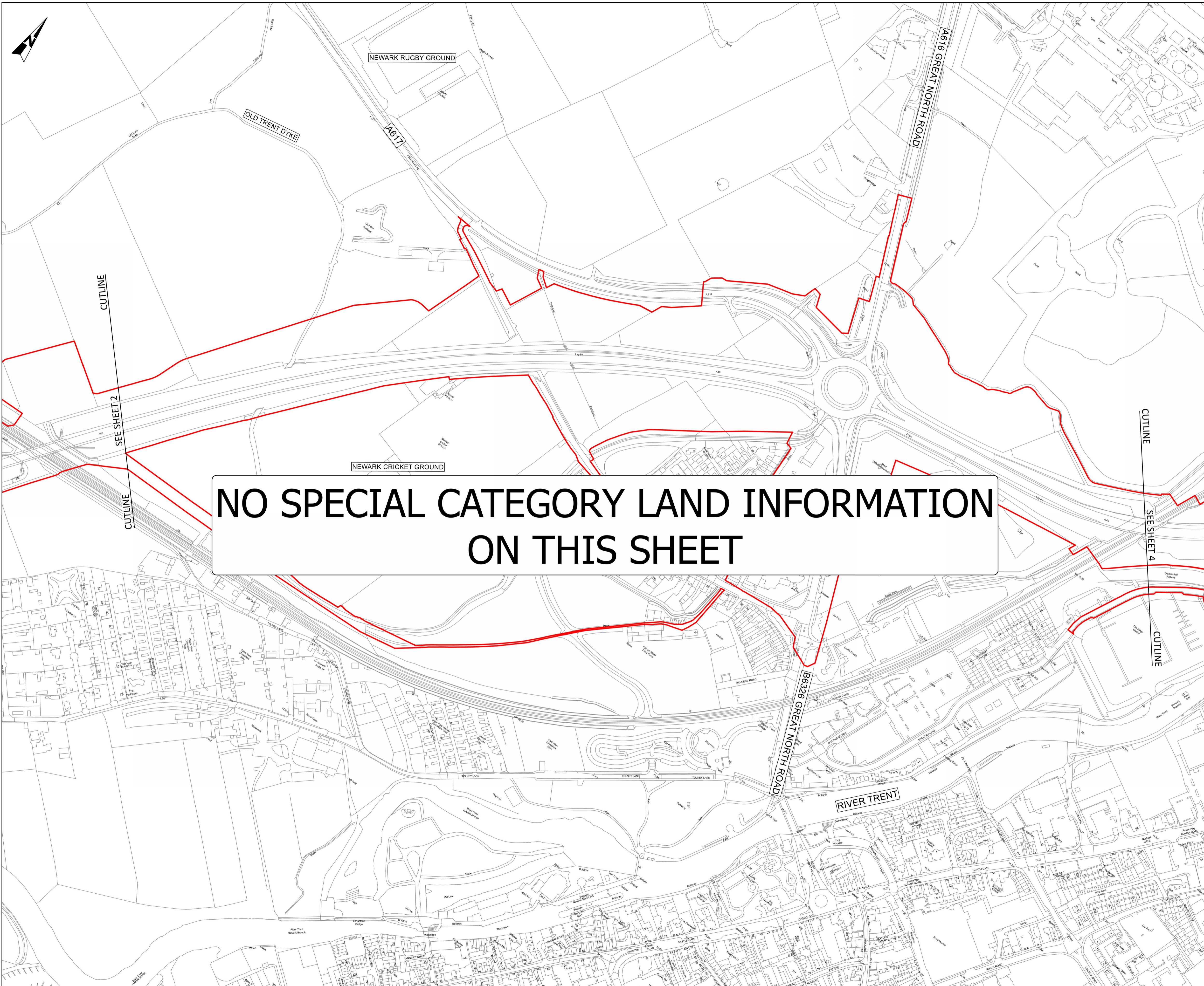

**NO SPECIAL CATEGORY LAND INFORMATION
ON THIS SHEET**

NOTES

- THIS PLAN SHOULD BE READ IN CONJUNCTION WITH THE LAND PLANS (TR010065/APP/2.2), CROWN LAND PLANS (TR010065/APP/2.11), BOOK OF REFERENCE (TR010065/APP/4.3), STATEMENT OF REASONS (TR010065/APP/4.1) AND THE DRAFT DCO (TR010065/APP/3.1).
- ALL DIMENSIONS ARE IN METRES UNLESS OTHERWISE STATED.
- DO NOT SCALE FROM THIS DRAWING, USE ONLY PRINTED DIMENSIONS.
- ALL EASEMENTS, SERVITUDES AND PRIVATE RIGHTS ARE PROPOSED TO BE EXTINGUISHED ON LAND THAT IS TO BE ACQUIRED UNLESS STATED OTHERWISE IN THE BOOK OF REFERENCE.
- THE NUMBER LABELS RELATE TO PLOT NUMBERS. PLEASE REFER TO THE BOOK OF REFERENCE FOR MORE INFORMATION ABOUT THESE PLOTS, INCLUDING THE APPROXIMATE AREA OF EACH PLOT. IN THIS NUMBERING CONVENTION, A PLOT NUMBER COMPRISES THE SHEET NUMBER FOLLOWED BY THE ACTUAL PLOT NUMBER, E.G: PLOT 1/1A, WHERE '1' IS THE SHEET NUMBER.

SERVICE LAYER CREDITS
 © CROWN COPYRIGHT AND DATABASE RIGHTS 2023 OS 100030649
 CONTAINS DATA FROM OS ZOOMSTACK
 © CROWN COPYRIGHT MATERIAL IS REPRODUCED WITH THE PERMISSION OF LAND REGISTRY UNDER DELEGATED AUTHORITY FROM THE CONTROLLER OF HMSO.

KEY TO SYMBOLS

	PLOT REFERENCE NUMBER (REFER TO BOOK OF REFERENCE)
	LAND TO BE PERMANENTLY ACQUIRED
	LAND TO BE USED TEMPORARILY AND RIGHTS TO BE PERMANENTLY ACQUIRED
	LAND TO BE USED TEMPORARILY
	LAND NOT SUBJECT TO COMPULSORY ACQUISITION
	ORDER LIMITS

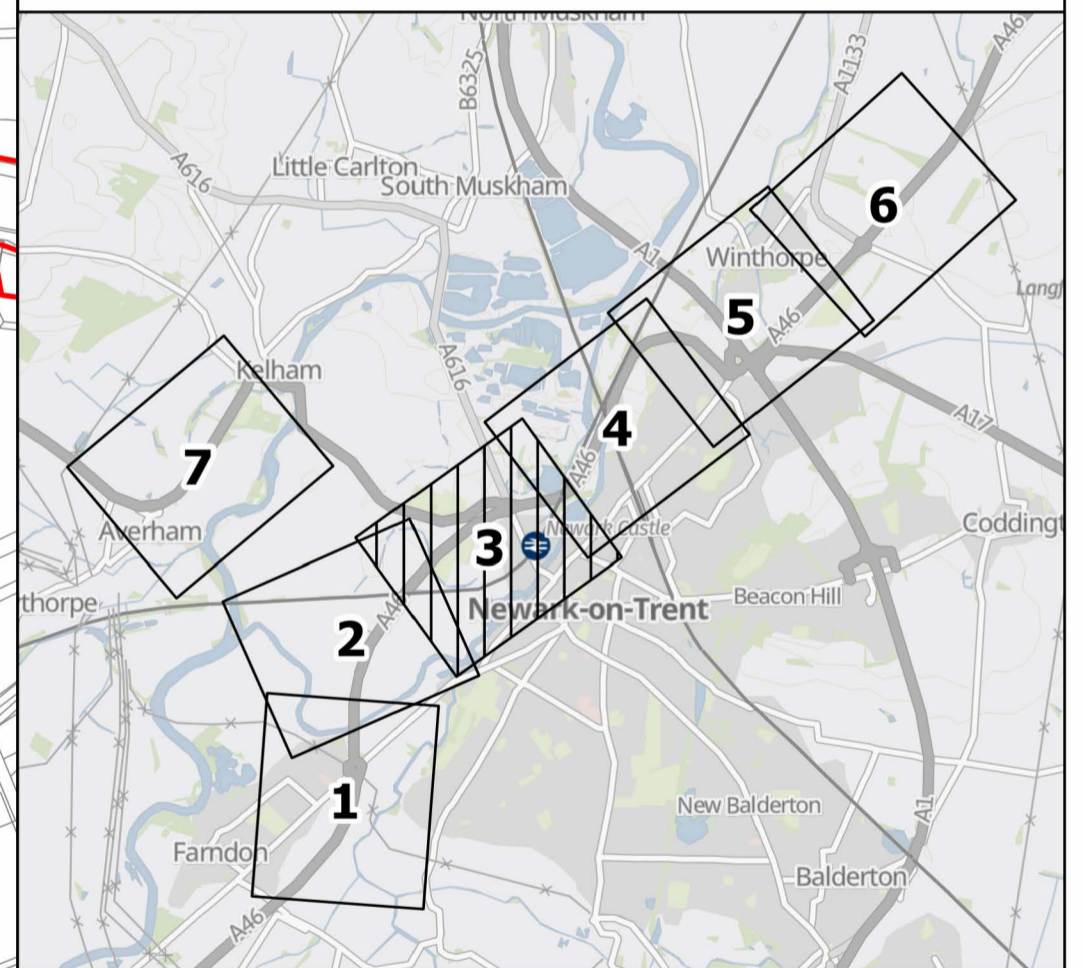

C02	26/03/2024	DCO SUBMISSION	AS	AL	HF
REV.	DATE	AMENDMENT DETAILS	ORIG	CHK'D	APP'D
CLIENT					
PURPOSE OF ISSUE		DCO APPLICATION			
DEVELOPMENT CONSENT ORDER NUMBER		TR010065			
PROJECT TITLE		A46 NEWARK BYPASS			
DRAWING TITLE		SPECIAL CATEGORY LAND PLANS REGULATION 5(2)(i)(iv) SHEET 3 OF 7			
ORIGINAL SIZE	A1	SCALE	1:2,500		
DRAWING NUMBER	ORIGINATOR	VOLUME	PROJECT REF NO.		
HE551478	SKAG	LL0	HE551478		
CONWI_CONW	DR	VT	00030	REVISION	
LOCATION	TYPE	ROLE	NUMBER	C02	

© Skanska
 This document is issued for the party which commissioned it and for specific purposes connected with the captioned project only. It should not be relied upon by any other party or used for any other purpose.
 We accept no responsibility for the consequences of this document being relied upon by any other party, or being used for any other purpose, or containing any error or omission which is due to an error or omission in data supplied to us by other parties.

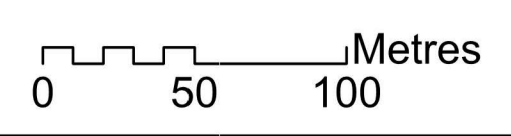

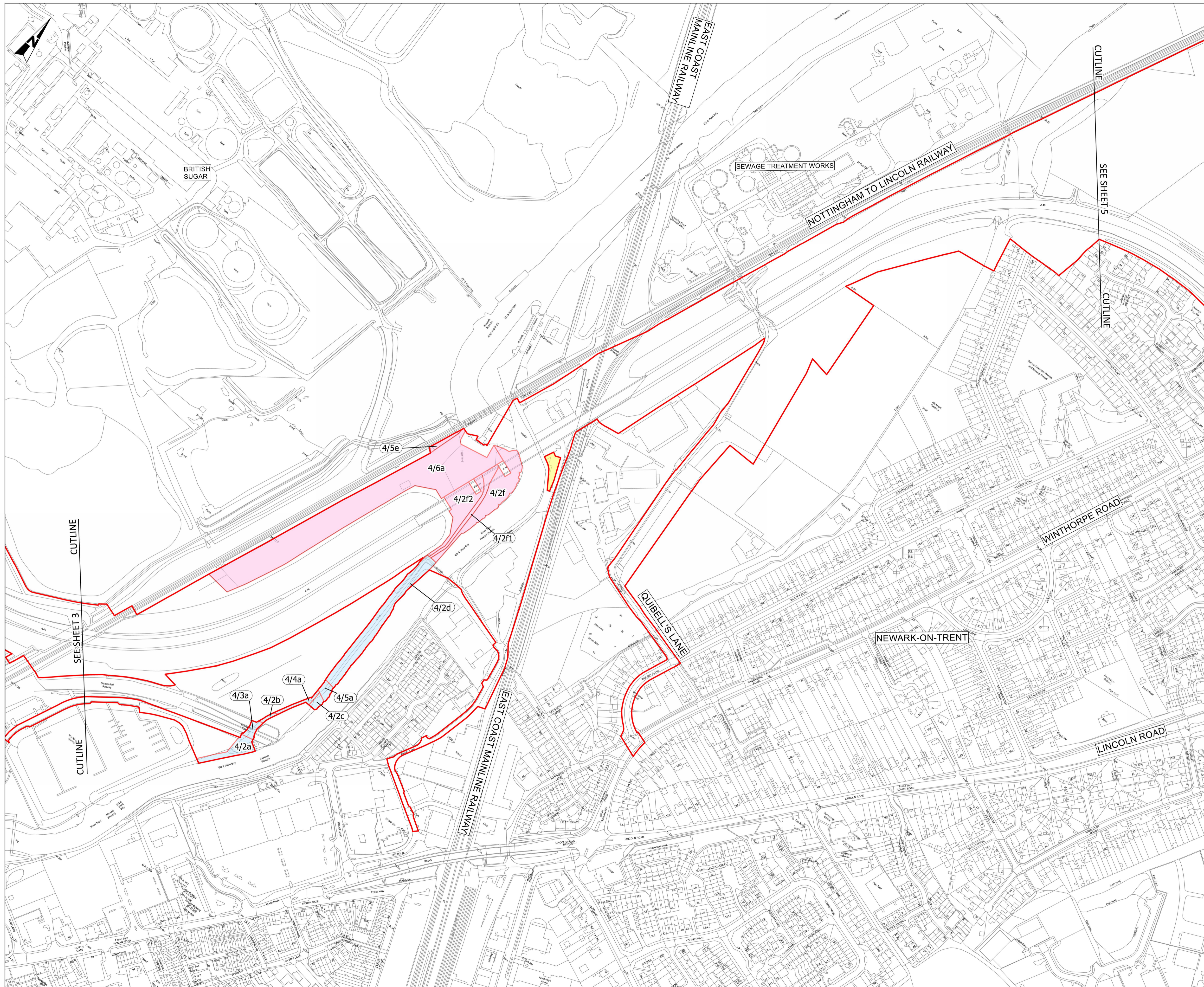

NOTES

1. THIS PLAN SHOULD BE READ IN CONJUNCTION WITH THE LAND PLANS (TR010065/APP/2.2), CROWN LAND PLANS (TR010065/APP/2.11), BOOK OF REFERENCE (TR010065/APP/4.3), STATEMENT OF REASONS (TR010065/APP/4.1) AND THE DRAFT DCO (TR010065/APP/3.1).
2. ALL DIMENSIONS ARE IN METRES UNLESS OTHERWISE STATED.
3. DO NOT SCALE FROM THIS DRAWING, USE ONLY PRINTED DIMENSIONS.
4. ALL EASEMENTS, SERVITUDES AND PRIVATE RIGHTS ARE PROPOSED TO BE EXTINGUISHED ON LAND THAT IS TO BE ACQUIRED UNLESS STATED OTHERWISE IN THE BOOK OF REFERENCE.
5. THE NUMBER LABELS RELATE TO PLOT NUMBERS. PLEASE REFER TO THE BOOK OF REFERENCE FOR MORE INFORMATION ABOUT THESE PLOTS, INCLUDING THE APPROXIMATE AREA OF EACH PLOT. IN THIS NUMBERING CONVENTION, A PLOT NUMBER COMPRISES THE SHEET NUMBER FOLLOWED BY THE ACTUAL PLOT NUMBER, E.G: PLOT 1/1A, WHERE '1' IS THE SHEET NUMBER.

SERVICE LAYER CREDITS
 © CROWN COPYRIGHT AND DATABASE RIGHTS 2023 OS 100030649
 CONTAINS DATA FROM OS ZOOMSTACK
 © CROWN COPYRIGHT MATERIAL IS REPRODUCED WITH THE PERMISSION OF LAND REGISTRY UNDER DELEGATED AUTHORITY FROM THE CONTROLLER OF HMSO.

KEY TO SYMBOLS

(x/xx)	PLOT REFERENCE NUMBER (REFER TO BOOK OF REFERENCE)
[Pink Box]	LAND TO BE PERMANENTLY ACQUIRED
[Light Blue Box]	LAND TO BE USED TEMPORARILY AND RIGHTS TO BE PERMANENTLY ACQUIRED
[Light Green Box]	LAND TO BE USED TEMPORARILY
[Yellow Box]	LAND NOT SUBJECT TO COMPULSORY ACQUISITION
[Red Line]	ORDER LIMITS

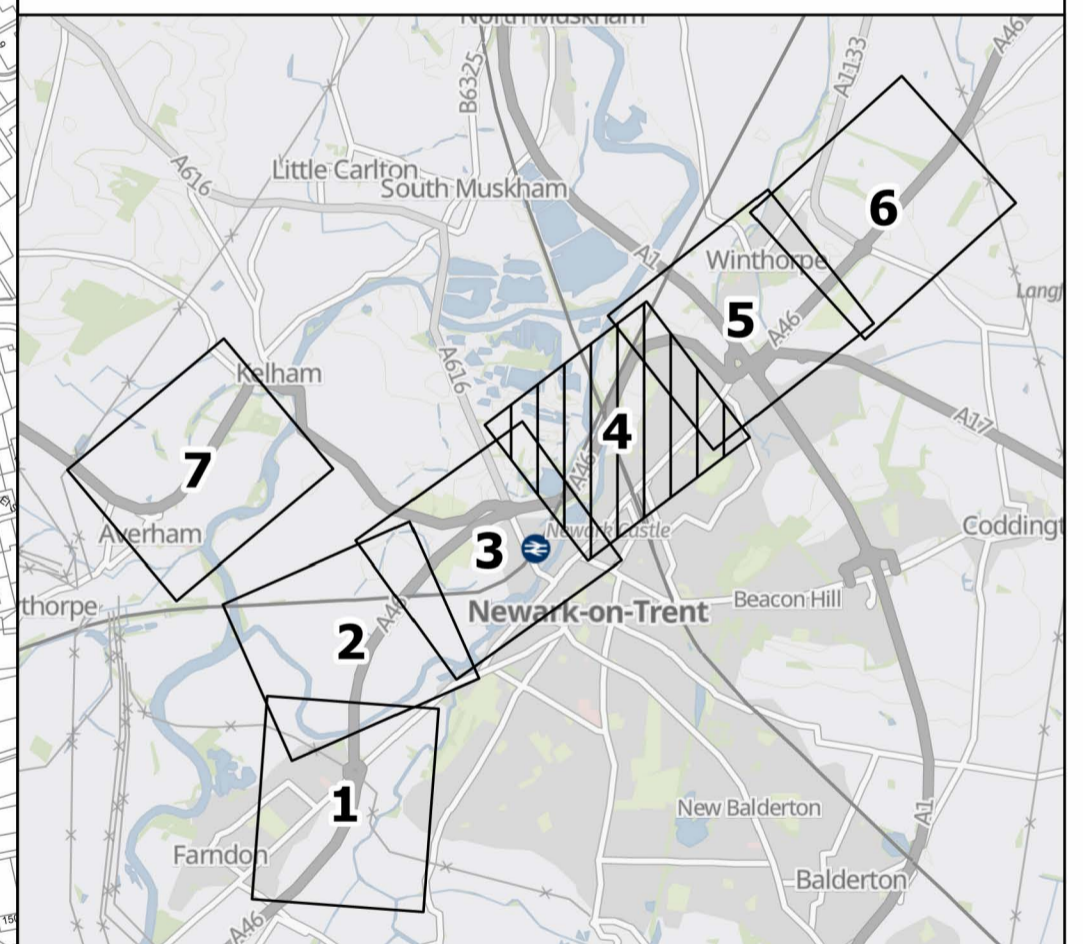

CO2	26/03/2024	DCO SUBMISSION	AS	AL	HF
REV.	DATE	AMENDMENT DETAILS	ORIG	CHK'D	APP'D

CLIENT

PURPOSE OF ISSUE: **DCO APPLICATION**

DEVELOPMENT CONSENT ORDER NUMBER: **TR010065**

PROJECT TITLE: **A46 NEWARK BYPASS**

DRAWING TITLE: **SPECIAL CATEGORY LAND PLANS REGULATION 5(2)(i)(iv) SHEET 4 OF 7**

ORIGINAL SIZE	A1	SCALE	1:2,500
---------------	----	-------	---------

DRAWING NUMBER	ORIGINATOR	VOLUME	PROJECT REF NO.
HE551478	SKAG	LL0	HE551478
LOCATION	TYPE	ROLE	REVISION
CONWI_CONW	DR	VT	C02
		00031	

© Skanska
 This document is issued for the party which commissioned it and for specific purposes connected with the captioned project only. It should not be relied upon by any other party or used for any other purpose.
 We accept no responsibility for the consequences of this document being relied upon by any other party, or being used for any other purpose, or containing any error or omission which is due to an error or omission in data supplied to us by other parties.

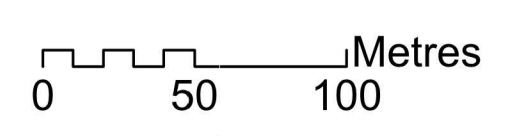

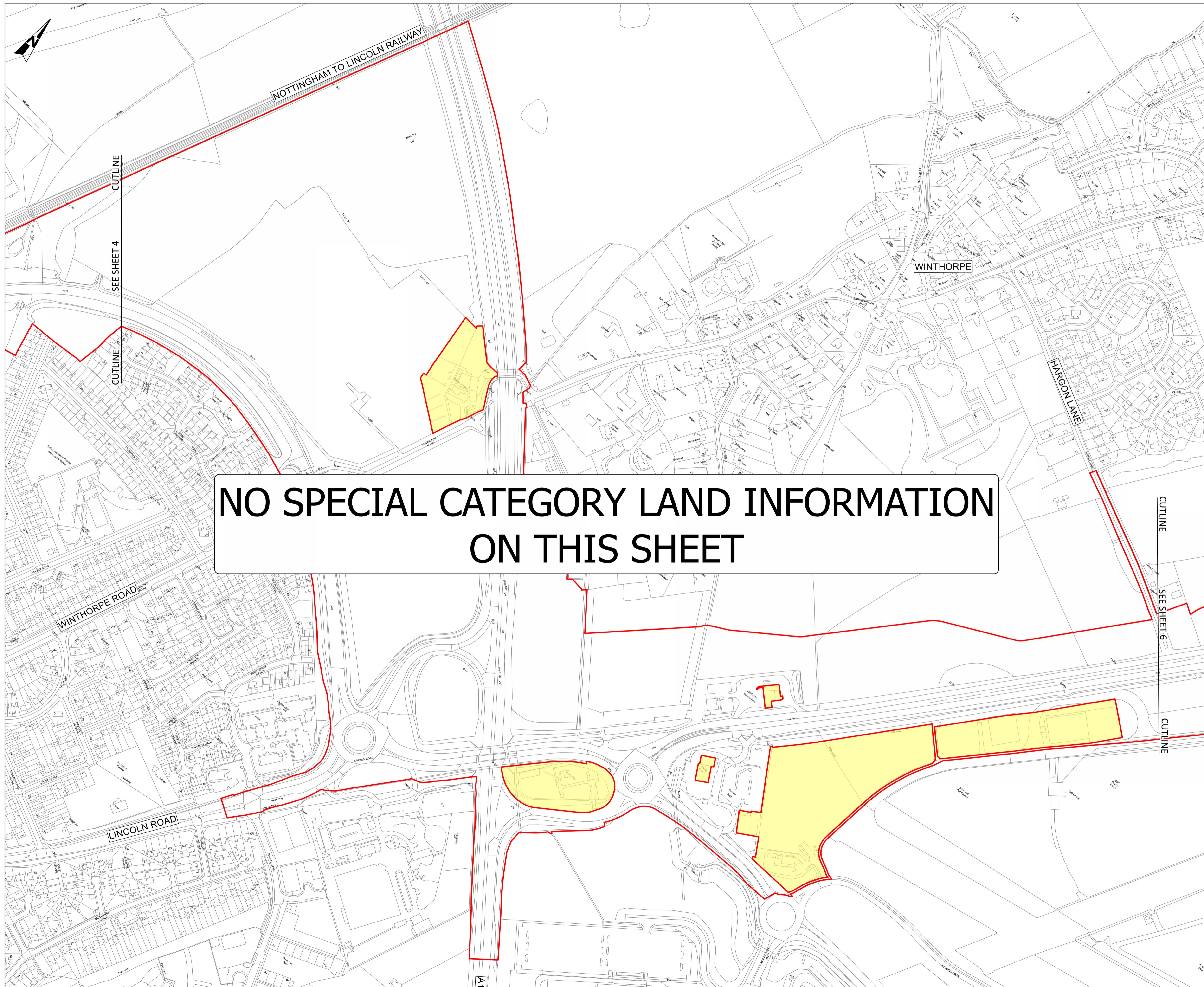

**NO SPECIAL CATEGORY LAND INFORMATION
ON THIS SHEET**

NOTES

1. THIS PLAN SHOULD BE READ IN CONJUNCTION WITH THE LAND PLANS (TR010065/APP/2.2), CROWN LAND PLANS (TR010065/APP/2.11), BOOK OF REFERENCE (TR010065/APP/4.3), STATEMENT OF REASONS (TR010065/APP/4.1) AND THE DRAFT DCO (TR010065/APP/3.1).
2. ALL DIMENSIONS ARE IN METRES UNLESS OTHERWISE STATED.
3. DO NOT SCALE FROM THIS DRAWING, USE ONLY PRINTED DIMENSIONS.
4. ALL EASEMENTS, SERVITUDES AND PRIVATE RIGHTS ARE PROPOSED TO BE EXTINGUISHED ON LAND THAT IS TO BE ACQUIRED UNLESS STATED OTHERWISE IN THE BOOK OF REFERENCE.
5. THE NUMBER LABELS RELATE TO PLOT NUMBERS. PLEASE REFER TO THE BOOK OF REFERENCE FOR MORE INFORMATION ABOUT THESE PLOTS, INCLUDING THE APPROXIMATE AREA OF EACH PLOT. IN THIS NUMBERING CONVENTION, A PLOT NUMBER COMPRISES THE SHEET NUMBER FOLLOWED BY THE ACTUAL PLOT NUMBER, E.G: PLOT 1/1A, WHERE '1' IS THE SHEET NUMBER.

SERVICE LAYER CREDITS
 © CROWN COPYRIGHT AND DATABASE RIGHTS 2023 OS 100030649
 CONTAINS DATA FROM OS ZOOMSTACK
 © CROWN COPYRIGHT MATERIAL IS REPRODUCED WITH THE PERMISSION OF LAND REGISTRY UNDER DELEGATED AUTHORITY FROM THE CONTROLLER OF HMSO.

KEY TO SYMBOLS

	PLOT REFERENCE NUMBER (REFER TO BOOK OF REFERENCE)
	LAND TO BE PERMANENTLY ACQUIRED
	LAND TO BE USED TEMPORARILY AND RIGHTS TO BE PERMANENTLY ACQUIRED
	LAND TO BE USED TEMPORARILY
	LAND NOT SUBJECT TO COMPULSORY ACQUISITION
	ORDER LIMITS

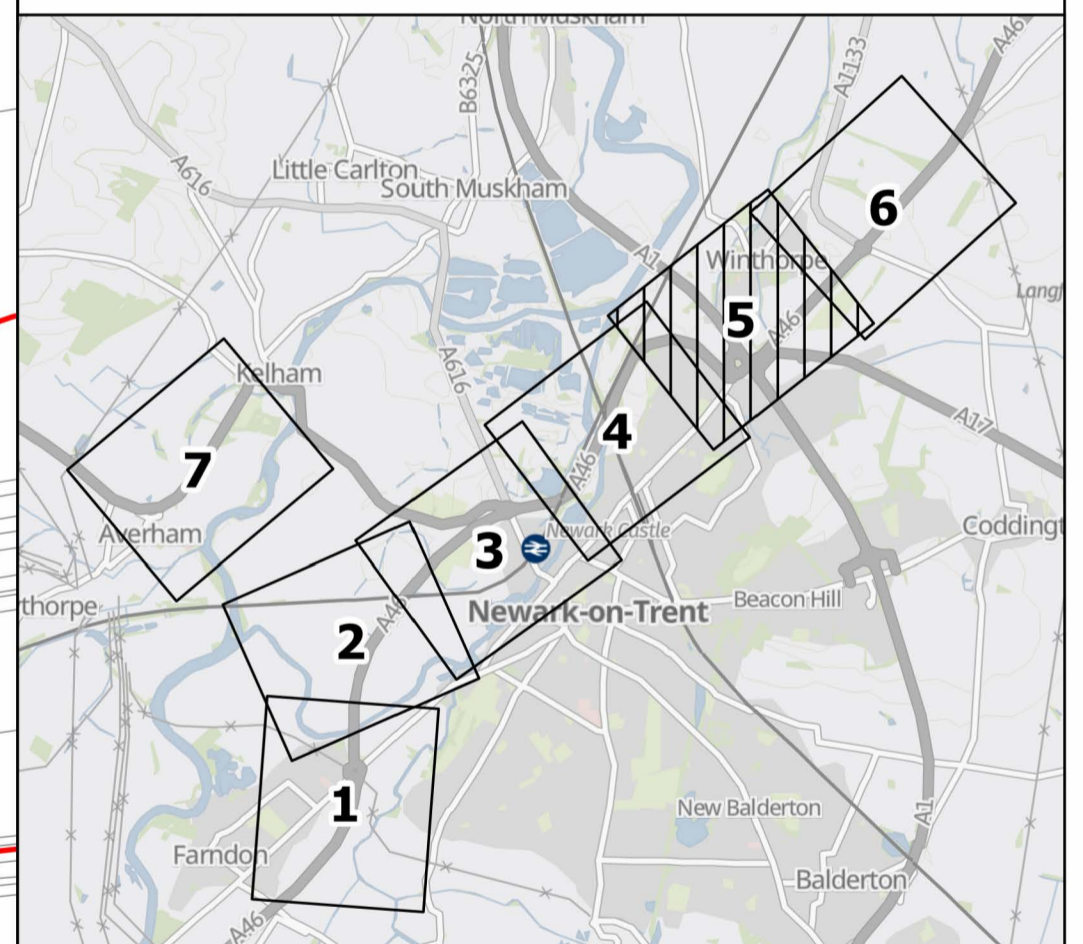

CO2	26/03/2024	DCO SUBMISSION	AS	AL	HF
REV.	DATE	AMENDMENT DETAILS	ORIG	CHK'D	APP'D

CLIENT

PURPOSE OF ISSUE: **DCO APPLICATION**

DEVELOPMENT CONSENT ORDER NUMBER: **TR010065**

PROJECT TITLE: **A46 NEWARK BYPASS**

DRAWING TITLE: **SPECIAL CATEGORY LAND PLANS
REGULATION 5(2)(i)(iv)
SHEET 5 OF 7**

ORIGINAL SIZE	A1	SCALE	1:2,500
DRAWING NUMBER	HE551478	ORIGINATOR	SKAG
HE FN	CONWI_CONW	VOLUME	LL0
LOCATION	DR	TYPE	VT
		NUMBER	00032
PROJECT REF NO.	HE551478	REVISION	C02

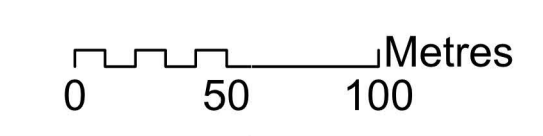



NOTES

1. THIS PLAN SHOULD BE READ IN CONJUNCTION WITH THE LAND PLANS (TR010065/APP/2.2), CROWN LAND PLANS (TR010065/APP/2.11), BOOK OF REFERENCE (TR010065/APP/4.3), STATEMENT OF REASONS (TR010065/APP/4.1) AND THE DRAFT DCO (TR010065/APP/3.1).
2. ALL DIMENSIONS ARE IN METRES UNLESS OTHERWISE STATED.
3. DO NOT SCALE FROM THIS DRAWING, USE ONLY PRINTED DIMENSIONS.
4. ALL EASEMENTS, SERVITUDES AND PRIVATE RIGHTS ARE PROPOSED TO BE EXTINGUISHED ON LAND THAT IS TO BE ACQUIRED UNLESS STATED OTHERWISE IN THE BOOK OF REFERENCE.
5. THE NUMBER LABELS RELATE TO PLOT NUMBERS. PLEASE REFER TO THE BOOK OF REFERENCE FOR MORE INFORMATION ABOUT THESE PLOTS, INCLUDING THE APPROXIMATE AREA OF EACH PLOT. IN THIS NUMBERING CONVENTION, A PLOT NUMBER COMPRISES THE SHEET NUMBER FOLLOWED BY THE ACTUAL PLOT NUMBER, E.G: PLOT 1/1A, WHERE '1' IS THE SHEET NUMBER.

SERVICE LAYER CREDITS
 © CROWN COPYRIGHT AND DATABASE RIGHTS 2023 OS 100030649
 CONTAINS DATA FROM OS ZOOMSTACK
 © CROWN COPYRIGHT MATERIAL IS REPRODUCED WITH THE PERMISSION OF LAND REGISTRY UNDER DELEGATED AUTHORITY FROM THE CONTROLLER OF HMSO.

KEY TO SYMBOLS

	PLOT REFERENCE NUMBER (REFER TO BOOK OF REFERENCE)
	LAND TO BE PERMANENTLY ACQUIRED
	LAND TO BE USED TEMPORARILY AND RIGHTS TO BE PERMANENTLY ACQUIRED
	LAND TO BE USED TEMPORARILY
	LAND NOT SUBJECT TO COMPULSORY ACQUISITION
	ORDER LIMITS

NO SPECIAL CATEGORY LAND INFORMATION ON THIS SHEET

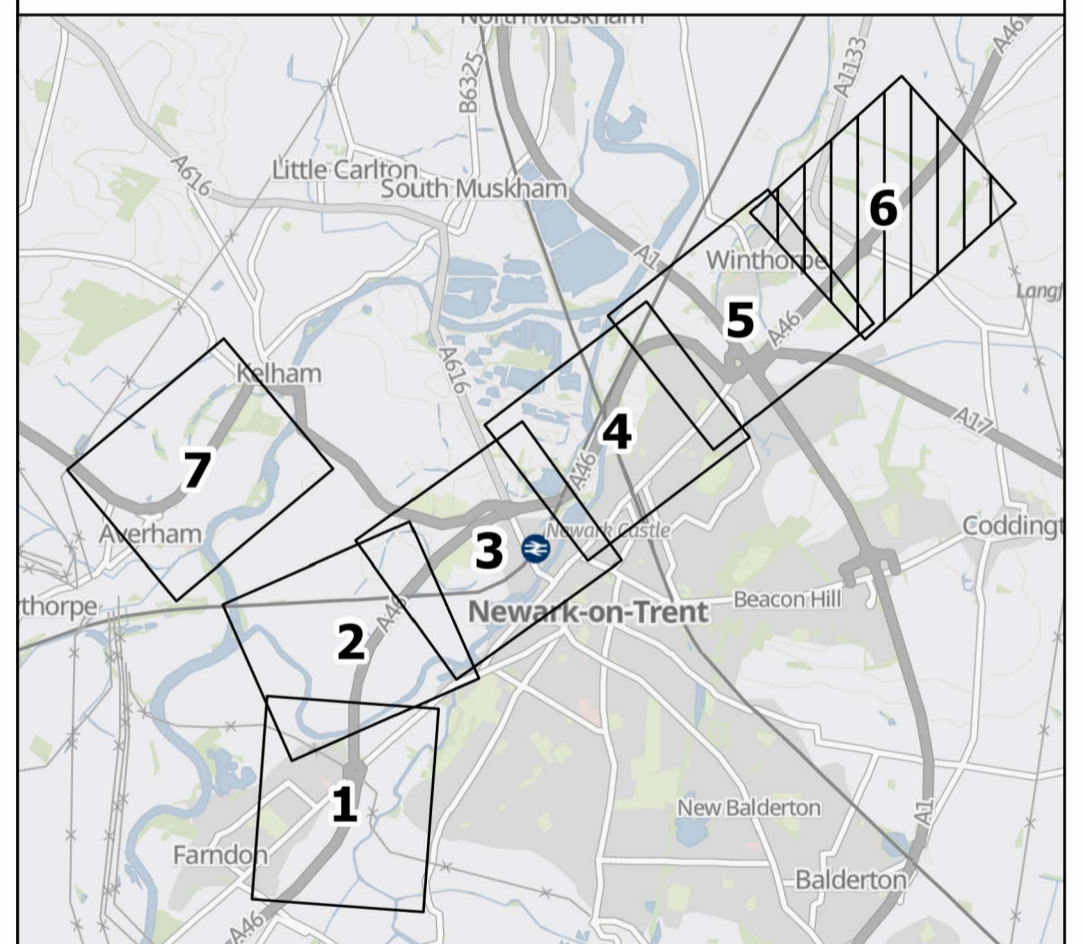

CO2	26/03/2024	DCO SUBMISSION	AS	AL	HF
REV.	DATE	AMENDMENT DETAILS	ORIG	CHK'D	APP'D

CLIENT

PURPOSE OF ISSUE: **DCO APPLICATION**

DEVELOPMENT CONSENT ORDER NUMBER: **TR010065**

PROJECT TITLE: **A46 NEWARK BYPASS**

DRAWING TITLE: **SPECIAL CATEGORY LAND PLANS REGULATION 5(2)(i)(iv) SHEET 6 OF 7**

ORIGINAL SIZE: A1 | SCALE: 1:2,500

DRAWING NUMBER HE551478	ORIGINATOR SKAG	VOLUME LLO	PROJECT REF NO. HE551478
LOCATION CONWI_CONW	TYPE DR	ROLE VT	REVISION C02
	NUMBER 00033		

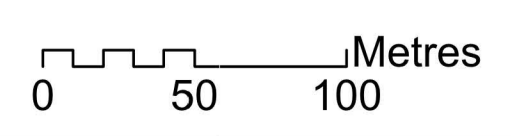



**NO SPECIAL CATEGORY LAND INFORMATION
ON THIS SHEET**

NOTES

1. THIS PLAN SHOULD BE READ IN CONJUNCTION WITH THE LAND PLANS (TR010065/APP/2.2), CROWN LAND PLANS (TR010065/APP/2.11), BOOK OF REFERENCE (TR010065/APP/4.3), STATEMENT OF REASONS (TR010065/APP/4.1) AND THE DRAFT DCO (TR010065/APP/3.1).
2. ALL DIMENSIONS ARE IN METRES UNLESS OTHERWISE STATED.
3. DO NOT SCALE FROM THIS DRAWING, USE ONLY PRINTED DIMENSIONS.
4. ALL EASEMENTS, SERVITUDES AND PRIVATE RIGHTS ARE PROPOSED TO BE EXTINGUISHED ON LAND THAT IS TO BE ACQUIRED UNLESS STATED OTHERWISE IN THE BOOK OF REFERENCE.
5. THE NUMBER LABELS RELATE TO PLOT NUMBERS. PLEASE REFER TO THE BOOK OF REFERENCE FOR MORE INFORMATION ABOUT THESE PLOTS, INCLUDING THE APPROXIMATE AREA OF EACH PLOT. IN THIS NUMBERING CONVENTION, A PLOT NUMBER COMPRISES THE SHEET NUMBER FOLLOWED BY THE ACTUAL PLOT NUMBER, E.G: PLOT 1/1A, WHERE '1' IS THE SHEET NUMBER.

SERVICE LAYER CREDITS
 © CROWN COPYRIGHT AND DATABASE RIGHTS 2023 OS 100030649
 CONTAINS DATA FROM OS ZOOMSTACK
 © CROWN COPYRIGHT MATERIAL IS REPRODUCED WITH THE PERMISSION OF LAND REGISTRY UNDER DELEGATED AUTHORITY FROM THE CONTROLLER OF HMSO.

KEY TO SYMBOLS

	PLOT REFERENCE NUMBER (REFER TO BOOK OF REFERENCE)
	LAND TO BE PERMANENTLY ACQUIRED
	LAND TO BE USED TEMPORARILY AND RIGHTS TO BE PERMANENTLY ACQUIRED
	LAND TO BE USED TEMPORARILY
	LAND NOT SUBJECT TO COMPULSORY ACQUISITION
	ORDER LIMITS

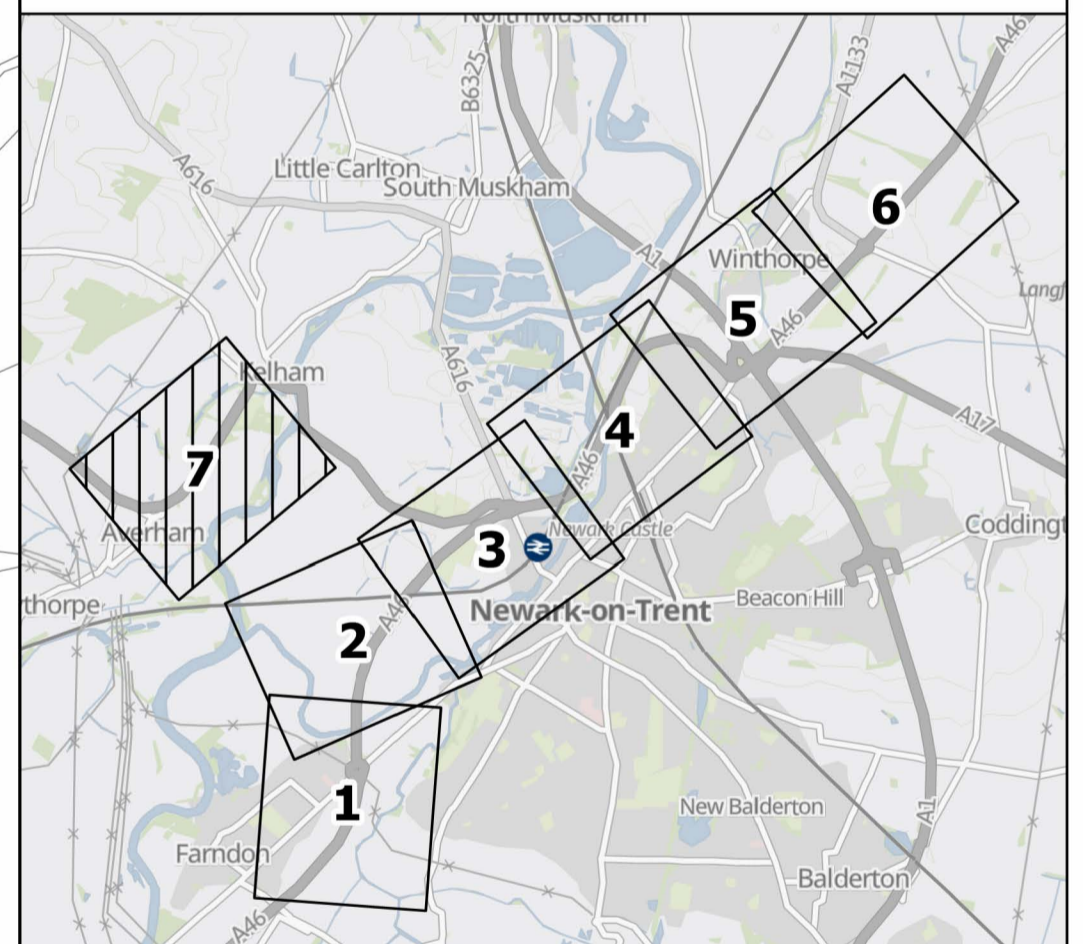

C02	26/03/2024	DCO SUBMISSION	AS	AL	HF
REV.	DATE	AMENDMENT DETAILS	ORIG	CHK'D	APP'D

CLIENT

PURPOSE OF ISSUE
 DCO APPLICATION

DEVELOPMENT CONSENT ORDER NUMBER
 TR010065

PROJECT TITLE
 A46 NEWARK BYPASS

DRAWING TITLE
 SPECIAL CATEGORY LAND PLANS
 REGULATION 5(2)(i)(iv)
 SHEET 7 OF 7

ORIGINAL SIZE	A1	SCALE	1:2,500
DRAWING NUMBER	HE551478	ORIGINATOR	SKAG
HE PIN	HE551478	VOLUME	LLO
CONWL_CONW	DR	VT	00034
LOCATION		TYPE	ROLE
		NUMBER	C02

